

VOLUME 66 NUMBER 14

APRIL 04, 2026

THE KWAJALEIN HOURGLASS





PHOTO BY ANNETTE MONK

COMMUNITY

THE LEAVING TREE: WHERE KWAJALEIN AND ROI-NAMUR SAY GOODBYE

Beneath its branches, goodbyes take root and memories grow.

HOURLASS REPORT

By Annette Monk, Hourglass Story Writer

On Kwajalein, goodbyes are never quiet.

Long before a flight boards, people begin gathering beneath a massive, weather worn tree near the airport—its branches stretching wide as if trying to hold on to everyone just a little longer. Known simply as the Leaving Tree, it has become one of the island's most meaningful landmarks, not because of a plaque or a name carved into its trunk, but because of the countless moments lived beneath its shade.

Coolers appear. Music drifts through the air. Friends, coworkers, neighbors, and families arrive with snacks, leis, handmade gifts, and the kind of stories that only make sense to those who have lived on “Kwaj.” What

unfolds is less a farewell and more a celebration of connection — a ritual that honors the people who shaped this place and the memories that will travel with them long after the plane lifts off.

For some, the Leaving Tree marks the start of a short vacation. For others, it marks the end of a chapter that changed them in ways they never expected. But the ritual remains the same: gather, acknowledge, and remember a tradition rooted in community.

“It’s an oddly sacred gathering place,” said Jody Baruth, former Marina Captain who departed in November. “Stories are embellished, drinks are toasted, and there’s a remembrance of what was lived and learned that will only make sense on Kwaj. It’s a final opportunity to say goodbye with friends and family.”

Kwajalein compresses time.



Relationships deepen quickly. Small moments become meaningful. And the Leaving Tree becomes the place where those moments are spoken aloud—sometimes for the first time. When people leave Kwaj, they don't just take suitcases. "They take a piece of our hearts," said Santana Spence, who has stood under the tree many times to say farewell. "The memories they created with close friends, the island magic—those things stay with them."

For Berlys Deardorff, who left in January, the tree offered a moment of clarity. "Standing at the Leaving Tree feels like acknowledging that my time here mattered," she said. "Kwaj isn't somewhere you just pass through. It leaves a mark." She spoke of friends who showed up for her in ways she never expected, of karaoke nights where confidence soared, of local bands, craft fairs, and the small kindnesses that made

the island feel like home. Even her blind cat, Stevie Wonder—rescued from the soccer fields—became part of her "Kwaj" story. "It wasn't one big moment," she said. "It was a collection of small ones. The random hangouts were always the best."

The Leaving Tree itself is a character in this tradition. Towering, resilient, and older than anyone can quite confirm, it has watched generations come and go. "It's likely the largest tree on Kwaj," said Mike Sakaio, RMI Relations Specialist. "It's been there for many years—maybe longer than we realize. It's sheltered people from sun and rain, hosted coconut husking demos during Manit Day, and served as a playground for children and birds alike." Some say the tree survived the bombardment of the Battle of Kwajalein. Whether myth or truth, the idea adds to its quiet power.

"If the tree could talk," said Larry Hensley, who left to be-



be a novel for sure. Pre war, post war, friendships, fish stories—the big one that got away. It’s seen everything.” Larry described his final farewell as both emotional and comforting. “It brought sadness because I was leaving my Kwaj family,” he said. “But also excitement for the future. The photos we took — I’ll cherish them. People showing up early meant something I did touched them in a positive way.”

For those who stay behind, the Leaving Tree is a reminder of the island’s transient nature. Contracts end. Opportunities shift. People move on. Yet the ritual soft-

ens the ache. “The Leaving Tree represents a bittersweet moment,” Santana said. “It’s sad to face the reality that someone you love is leaving, but it’s also a celebration of growth and new opportunities.”

Even in the hardest good-byes, there is gratitude. Kwajalein teaches patience, flexibility, and appreciation for the small things: expired Bud Light, delayed mail, shared meals, and the comfort of knowing someone will always show up when you need them.

“Kwaj is all about community if you lean into it,” Jody said. “Everyone rallies,

regardless of nationality or contract.”

Whether someone leaves for two weeks or forever, the Leaving Tree marks a crossing. It honors what was, acknowledges what is ending, and quietly blesses what comes next. “I hope I carry the perspective I gained here,” Berlys said. “Slowing down. Appreciating connection. Showing up for people.”

Larry echoed that sentiment. “It helped me find closure,” he said. “And it opened opportunities to visit friends in the States. I’ll always remember that day.”

And for those who remain, the message is simple. “Don’t

pass up the chance to send off a friend,” Larry said. “It means more than you know.”

Long after each plane disappears into the horizon, the Leaving Tree remains with its branches still stretching wide, ready for the next gathering, the next celebration, and the next goodbye. It stands as a reminder that while people may leave the island, the island never truly leaves them. And for everyone who has stood beneath its shade, the Leaving Tree becomes part of the story they carry forward—a symbol of community, connection, and the rare magic of life on Kwajalein. ▼

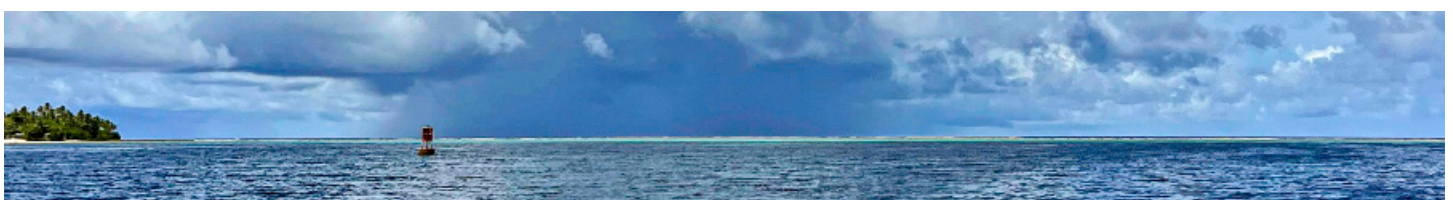



Front Cover: The Leaving Tree by Annette Monk

Back Cover: Roi Relaxation by Annette Monk

The Kwajalein Hourglass is named for the insignia of the U.S. Army's 7th Infantry Division, which liberated the island from the forces of Imperial Japan on Feb. 4, 1944. The Kwajalein Hourglass is an authorized publication for military personnel, federal employees, contractor workers and their families assigned to U.S. Army Garrison-Kwajalein Atoll.

Contents of the Hourglass are not necessarily official views of, or endorsed by, the U.S. Government, Department of War, Department of the Army or USAG-KA. It is published Saturdays in accordance with Army Regulation 360-1.
 Phone: Defense Switching Network: 315-480-5169
 Local phone: 480-5169

Garrison Commander.....Col. Matthew Cannon
 Garrison CSM.....Command Sgt. Maj. Stanley Jackson
 Public Affairs Officer.....Sherman Hogue
 Editor.....Muhammad Rasheed
 Communications Specialist, Sr.....Isaiah Matthews
 Communications Specialist.....Stephen Elson
 Communications Specialist.....Anthony Carnelli
 Story Writer.....Annette Monk
 Story Writer.....Christy Wagnon
 Media Capture.....Raneesh Thiruvath



📷 COURTESY PHOTOS

COMMUNITY

SPRING CAMP WEEK: INSECTS, ISLAND CAREERS, AND COMMUNITY ADVENTURES

Inspiring curiosity. Building confidence. Connecting youth to community.

HOURLASS REPORT

By Annette Monk, Hourglass Story Writer

Kwajalein’s Spring Camp Week was a joyful mix of science, creativity, and community exploration. Children in grades K-6th spent the week learning about the fascinating world of insects while also discovering the many careers and community helpers who keep island life thriving. Organized by the SAC – School Age Childcare team, the program highlighted how learning can be both hands on and deeply connected to real life.

Campers explored how insects like ladybugs, beetles, butterflies, honeybees, ants, and grasshoppers support our environment. They learned how these creatures pollinate plants, enrich soil, and help maintain balance in nature. STEM activities such as Bug

Bingo, scavenger hunts, insect life cycle sequencing, and Bug Showcase presentations encouraged critical thinking while keeping the learning fun and interactive.

Creativity was everywhere. Campers crafted coffee filter butterflies, honeycomb bubble wrap prints, bee finger puppets, and STEM tunnel creations. Even snack time became part of the theme, with green smoothies, “Ants in the Sand” treats, and butterfly fruit cups adding a playful twist to healthy eating.

One of the highlights of Spring Camp was the series of community field trips. Children visited the Fire Department, Police Station, Audio Visual Department, Library, Emon Beach, Youth Center, and Family Pool. At the Fire Station, they completed a scavenger hunt and explored emergency equipment. At the Audio-Visual Department,



they practiced mock interviews and learned how technology supports communication across the island. Each stop gave campers a chance to meet community helpers, ask questions, and see how different departments contribute to daily life on Kwajalein. Here's a breakdown of the Spring Camp Week logistics with the coordinator's perspective shared by Erica Simon, Youth Education Supervisor.

On blending environmental education with career exploration: "Spring Camp was intentionally designed to connect environmental education with real world career exploration. By learning about insects and their important role in our ecosystem, students were able to understand how nature supports our daily lives. We paired these lessons with field trips to community departments so children could see how different careers also help maintain a safe, healthy, and functioning communi-

ty. This combination helps students make meaningful connections between classroom learning and real life. My hope is that it inspires curiosity, builds awareness of future career possibilities, and helps children see themselves as capable contributors to their community and environment."

On selecting field trip locations: "When selecting field trip locations, I first consider what resources and opportunities are available within our unique Kwajalein community. Although the island is small, we truly have everything needed to live, work, stay healthy, and remain protected. This makes it a wonderful living classroom for our SAC students. To ensure visits are educational and engaging, students prepare ahead of time by learning about each department and its role in the community. After each visit, we hold group reflections where students discuss key takeaways, share highlights, and talk about



their most memorable moments. This preparation and reflection process helps deepen understanding and makes the experiences more meaningful and lasting."

On memorable moments from Spring Camp: "One of the most meaningful aspects of Spring Camp was the genuine excitement from community members who were eager to host and engage with our SAC students. Seeing departments welcome the children with enthusiasm reinforced the strong sense of community that makes Kwajalein special. A particularly memorable moment was visiting the Audio Visual Department (AVD). This was the first time CYS students had the opportunity to explore that space, and it opened up a completely new area of discovery for them. Introducing students to new environments and possibilities is always rewarding."

On the future of Spring Camp: "Spring Camp serves as a one week adventure for

a smaller group of SAC students, but it also acts as a precursor to our larger SAC Summer Camp, which runs from May 26 through August 15 and typically welcomes many more participants. In the future, I see Spring Camp continuing to grow through thoughtfully curated lesson plans that align with community field trips. This approach allows teachers to intentionally connect learning themes with real world experiences. By expanding partnerships and continuing to create hands on opportunities, we can further support students' curiosity, build their confidence, and strengthen their connection to the Kwajalein community. Our goal is to nurture curiosity today, so they grow into confident, capable leaders tomorrow."

Spring Camp is more than just a week of activities — it is an opportunity for our children to explore their environment, discover new interests, and build meaningful connections within the Kwajalein



community. When students can see, touch, and experience how their community works, learning becomes exciting, personal, and memorable.



Spring Camp Highlights

Community Field Trips

- Fire Department, Police Station, Audio Visual Department, (AVD), Library Emon Beach, Youth Center, & Family Pool

Our campers learned about important community helpers while building confidences, independence, and friendships.

Creative Snack Activities

- Green Smoothies
- "Ants in the Sand" treats
- Butterfly Fruit Cups

Art Activities

- Coffee Filter Butterflies
- STEM Tunnel Creations
- Honeycomb Bubble Wrap Prints
- Bee Finger Puppets
- Bug Bingo
- Bug Scavenger Hunt
- Bug Showcase Presentations

STEM Activities

- Bug Bingo
- Bug Spoo-we presentations

Our campers learned, played, and grew together through these fun, engaging experiences.



PHOTOS BY ANTHONY CARNELLI

ABOVE: The individual depicted is not actually receiving dental hygiene treatment, and is not a real patient. Photo is for aesthetic purposes only

COMMUNITY HEALTH

HEALTHY TEETH HABITS: HOW TO PREVENT A DENTAL EMERGENCY WHILE LIVING ON KWAJALEIN

Veteran dental hygienist at the Dental Clinic shares practical tips to keeping your teeth in check

HOURLASS REPORT

By **Anthony Carnelli**,
Hourglass Story Writer

It can start with something small: a soda sipped slowly through the afternoon, leftover cookies on the counter or a few mints spread throughout the day. Add in the times people skip brushing, rush through flossing or put off basic dental care, and those habits can add up faster than many realize — and over time, they can do real damage to teeth.

Kwajalein's current dental hygienist, Norman Evans, brings more than 30 years of experience to the job, with past work in Augusta, Georgia, Iraq and now Kwajalein. Drawing on that background,

Evans says understanding how sugar affects the mouth — and making a few simple changes in daily habits — can help prevent tooth decay, gum disease and avoidable pain.

The 20-Minute Acid Clock

Each time sugar touches your teeth, bacteria in your mouth feast on it and produce acid. That acid attacks your enamel, the protective coating on your teeth, for about 20 minutes before your saliva helps wash it away and restore balance. But the trouble is not just how much sugar you eat — it is how often.

"Every time you expose your teeth to sugars, you get 20 minutes of acid production if you don't rinse your mouth or brush," Evans said.

Here's why that matters — between acid attacks, saliva works to repair enamel through a process called re-mineralization. But when sugar exposures stack up throughout the day, teeth spend more time under assault than in recovery. Each new exposure resets the clock, and the cumulative damage can outpace the mouth's ability to heal itself. Over time, enamel weakens and breaks down — and that's when cavities form. The key is to give enamel time out of the acid bath.

At first, Evans's advice can sound counterintuitive. He explains that sipping a single can of soda over five hours is far worse for your teeth than drinking two cans — one with lunch and one with din-

ner. Two cans create two acid cycles. One can nursed all afternoon keeps that cycle starting over for hours.

"If you don't finish it, throw it away," Evans said. "And if you find yourself consuming a lot of sweets, drink water."

Common Habit Traps & The Mint Lady

Grazing on sweets throughout the day is one of the most common pitfalls — according to Evans. A piece of candy here, a sugary drink there — each one restarts that 20-minute acid production clock.

But the biggest culprit might surprise you.

"Mints are the worst," Evans said. Unlike a candy bar that takes a few minutes to eat, mints, lollipops, etc. are

designed to be savored. People pop one after another throughout the day, each one triggering a fresh round of acid production.

He recalled a patient in Atlanta known in the office as “the mint lady.” Evans said she kept a bowl of mints at her desk and sucked on them constantly. What began as a single cavity led to a root canal and a crown, costing \$2,500 at the time. A year later, after another steady stretch of mints, decay had formed around the crown, requiring an extraction and a bridge that added another \$3,000. The cycle continued.

“My mother also sucked mints all the time,” Evans said. “She ended up having to take all her teeth out.”

Sugar-free mints and chewing gum are a safer alternative, though it pays to check the label. Sugar-free gum can help by stimulating saliva production, which supports remineralization, or how your teeth rebuild and strengthen themselves.

A Reset Routine That Works Anywhere

When brushing isn’t possible — at the beach, at a work function, or after a community event, a simple water rinse helps.

“If you don’t have a toothbrush or can’t floss, just rinse your mouth out with water,” Evans said. “The goal is to reduce acidity.”

When you do brush, technique matters more than frequency. According to Evans, he sees patients who brush three times a day but do it poorly, which is counterproductive. His recommendation: use a soft toothbrush angled at **45 degrees** toward the gum line, brush in a circular motion and take your time.

“They should feel nice and smooth like glass,” he said. “If your teeth aren’t, just go back and brush again until they’re clean.”

The Step That Most People Skip

The National Library of

Medicine reports that about 70% of Americans do not floss daily, a habit that can contribute to periodontal disease and tooth decay.

“Brushing is 60% of cleaning and flossing is the other 40%,” Evans said. “If you never floss your teeth, you’re only cleaning 60%.”

Food debris left between teeth becomes a breeding ground for bacteria, which forms a sticky substance that we know of as plaque. Over time, minerals in saliva harden that turn plaque into calculus — the crusty buildup hygienists scrape away during cleanings. Left unchecked, it irritates gums, causing the bleeding and swelling known as gingivitis. If it progresses further, the bone supporting your teeth can be damaged.

Other Habits To Watch

Chewing ice is another habit Evans warns against. “It will crack your teeth,” he said. He explained that the extreme cold and hard surface can create stress fractures, leaving teeth vulnerable to breaking later — even while

chewing something as soft as bread.

People who grind their teeth at night face similar risks. Evans said that if you’re a teeth grinder, it’s best to wear a guard at night.

And, even “healthy” snacks deserve a second look.

“Protein bars can be bad,” he said. Sometimes they have a lot of sugar. And if they don’t have a lot of sugar, they usually taste pretty bad.”

Why Regular Cleanings Matter...A LOT

Hygienists like Evans catch problems that aren’t visible in the mirror — early gum disease, plaque buildup in hard-to-reach spots, and signs of decay between teeth.

Staying diligent between visits makes all the difference. Small, consistent habits can prevent the kind of damage that requires major intervention later. That is why, for Evans, the most rewarding part of the job is not the cleaning itself, but the opportunity to teach.

“The most rewarding thing is educating people

about their hygiene,” he said. “If you do the basics, you’re going to be okay.”

Treats and sweet drinks are part of life — holidays, celebrations or just an ordinary afternoon. The goal isn’t perfection. It’s enjoying them without turning every day into an all-day acid marathon — and leaning on steady habits that keep teeth healthy and saving you money over the long haul. ❏

Simple Tips To keep Your Teeth Out of Trouble

- Don’t sip sugary drinks all day — finish them within 20 minutes, or skip them.
- If you can’t brush, rinse with water to cut the acid.
- Brush gently at the gum line with a soft toothbrush.
- Floss daily — brushing alone only gets 60% of the job done.
- Skip the ice chewing — it can crack your teeth.





PHOTO BY SHERMAN HOGUE

ABOVE: USARPAC Maj. General Lance Okamura shakes the hand of Kwajalein Atoll's longest continuous worker, Maiza Bajo.

GARRISON NEWS

DECADES OF DEDICATION: USARPAC LEADERSHIP HONORS KWAJALEIN'S LONGEST SERVING WORKERS

During a recent visit to Kwajalein, U.S. Army Pacific Command leaders paused to recognize employees who have spent decades helping sustain the mission

HOURLASS REPORT

By **Anthony Carnelli**,
Hourglass Story Writer

They lined up in rows outside the U.S. Army Garrison-Kwajalein Atoll headquarters on March 25 — not for a formation, nor for an inspection but because a high-ranking Lt. General amongst Garrison leaders wanted to look them in the eye and say thank you.

Lt. General Lance Okamura, part of the U.S. Army Pacific leadership team visiting Kwajalein Atoll, stood before several lines of Garrison workers who share one distinction — each has served on the installation for 20 years or more. Some have been here far longer. One

man has been at it for more than half a century.

The brief, but impactful ceremony, introduced by Major Dan Rothenberger, Director of Host Nation Activities, was part of a broader USARPAC visit to the atoll. General Ronald Clark, commanding general of U.S. Army Pacific, and Okamura traveled from Hawaii to take a deeper look at conditions across Kwajalein — from infrastructure to the welfare, rights and morale of the workforce.

Garrison Commander Col. Matthew Cannon set the tone with a brief but pointed introduction, reminding the assembled workers that although Kwajalein's mission never stops, the people who sustain it deserve to be recognized.

"This morning is about taking the time to recognize the people who have dedicated decades of their lives to servicing the important mission that gets done here — that incredible partnership that we have between the Marshallese people and the U.S. Army Kwajalein Atoll," Cannon said.

He addressed the workers directly, offering what he called a sincere thank you for their hard work and dedication — acknowledging that they have watched commanders come and go and witnessed decades of change across the atoll, yet their commitment has remained steadfast.

Among the workers assembled was Maiza Bajo, a Marshallese employee who

commutes daily from Ebeye and has been working on the atoll since 1972 — 54 years of continuous service to the Garrison. Bajo, the head custodian of the Bachelor Quarters buildings on Kwajalein, has taken on a wide range of roles over the decades, from working the front desk at the *Kwaj Lodge* to handling custodial responsibilities at BQs on Roi-Namur. He says the reason is simple: the Garrison has treated him well, and the work he's done over all these years has supported his family.

Others in the group had also spent decades on Kwajalein. Robert Scholar, who lives on the island, has served the garrison for more than 40 years, and several of those recognized came from fami

lies with multiple generations of service to the installation.

Lt. General Okamura spoke directly to the workers about what their presence on the line represented.

“This is a sign that you have been dedicated your lives here,” Okamura said. It’s not lost on me that many of you forgo whatever pursuits in life and make tremendous sacrifices to serve here on Kwajalein.

He connected their work to a principle that defines the command’s broader mission.

“One of our biggest mottos in the U.S. Army Pacific is called ‘One-Team,’” Okamura said. “We’re not just a team of soldiers, we’re not just a team of government officials, we’re a team of international supporters from the people of the Marshall Islands.”

He closed with a word borrowed from his home state of Hawaii: “It’s my honor to say thank you, mahalo, for all that you’ve done.”

Before the workers returned to their usual duties, Okamura moved down the line and shook each hand in

turn — a small gesture, but one that carried the weight of decades. The moment served as a quiet acknowledgment

that the people who have sustained Kwajalein the longest are more than part of the background; they are part of

the reason it endures. ▾



PHOTO BY ANTHONY CARNELLI



PHOTO BY ANTHONY CARNELLI

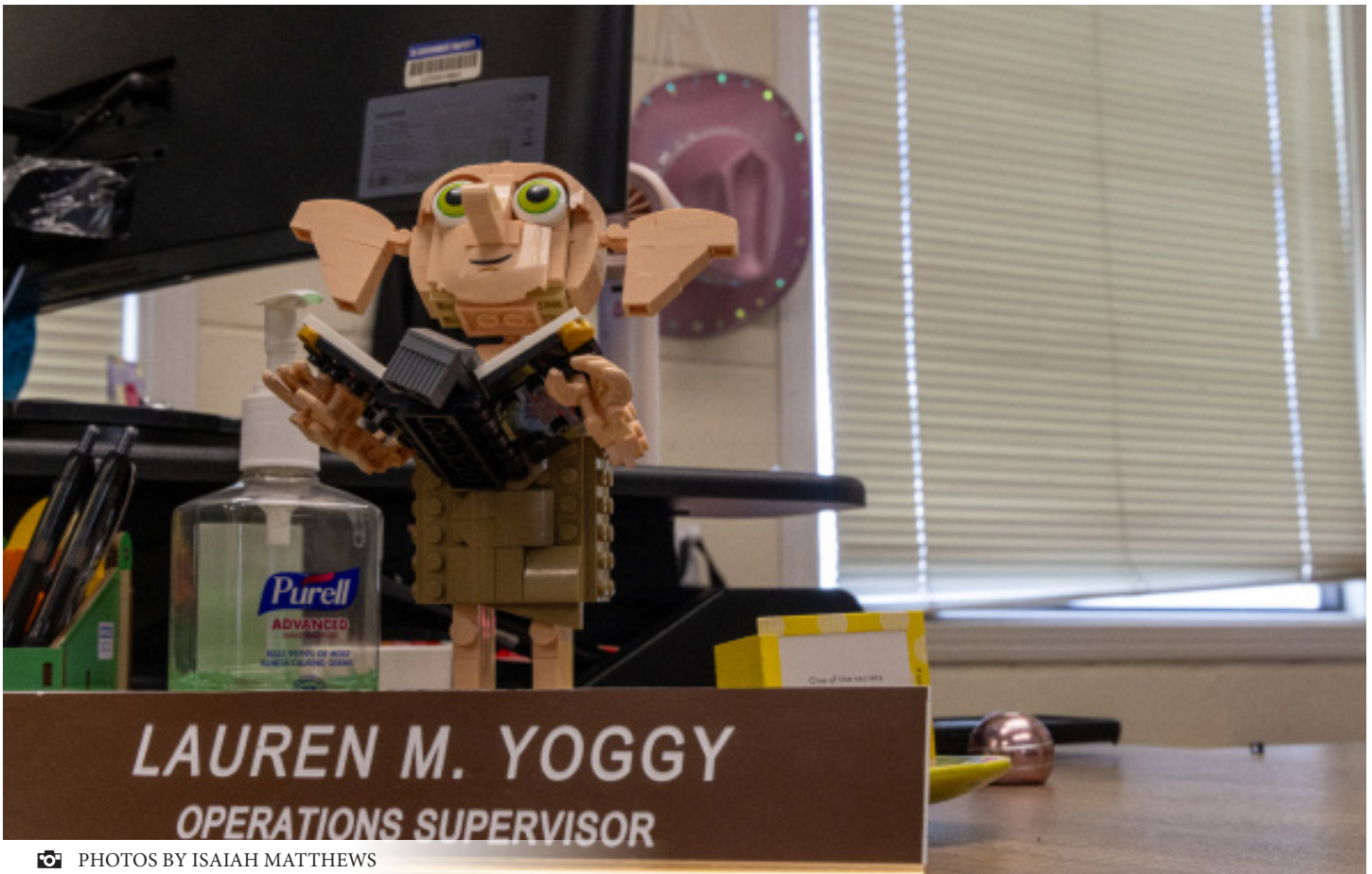

PHOTOS BY ISAIAH MATTHEWS

COMMUNITY

BRICK BY BRICK: INSIDE THE MIND OF A BUILDER

HOURLASS REPORT

By **Isaiah Matthews**,
Hourglass Story Writer

For some people, the end of the day means turning on the television or scrolling through a phone.

For Lauren Yoggy, an operations supervisor, it means something quieter. A table in her room. A box of carefully numbered bags. Hundreds, sometimes thousands of pieces waiting to become something whole.

What began as a recommendation from friends has become a mental reset, a creative challenge, and, in many ways, a form of discipline.

"A few friends said it was good for their mental health,"

she said. "And I did it. It's nice."

At first glance, LEGO building may seem simple: follow the instructions, connect the pieces, admire the finished product. But for her, the process goes much deeper than that.

"I do like art, but I just think it's just peaceful," Yoggy stated with a smile shooting across her face. "It kind of goes clear when you're following the instructions."

That phrase, it goes clear, says everything. For her, the build creates a kind of mental narrowing, where the noise of the day falls away and only the immediate task remains. The mind stops racing ahead. There is only the next step.

The next piece. The next page. In a world that often feels repetitive, fast-moving, and

mentally crowded, the build gives her something precise and manageable. Every piece has a place.

Every mechanism has a purpose. Every step leads somewhere.

"Seeing how different things go together to make other things work," she exclaimed ecstatically. "Just that one button makes all, like, three different things happen."

That fascination reveals something about the way she thinks. She is not simply interested in what the set looks like when it is done. She is drawn to how it works. The internal logic. The hidden mechanics. The cause and effect.

"This makes me think about engineering when I do build," said Yoggy.

For her, the satisfaction

comes from understanding the system behind the structure.

That mindset also shapes the way she approaches difficulty. Some people want fast gratification. He prefers the opposite.

"I think the longer it takes me to build, the more interested I am in it," she said. "If I can finish it in one night, I'm like, what do I do tomorrow?"

That quote reveals something almost philosophical.

She is not chasing the finished object. She is chasing the process.

The build itself is the reward. The time spent focused is more valuable than the shelf display at the end. That is why repetition, when it feels mindless rather than purposeful, loses him.

"I don't like it," he said. "They are so repetitive and it's boring."



I did this and I have to do it ten more times.”

The distinction is important. Yoggy wants challenge, not monotony. Complexity, not mechanical repetition. That preference says a great deal about the builder’s mindset.

She values growth. She wants to stay mentally engaged. Even mistakes become part of that process.

“Sometimes the piece is so similar you find out it’s the wrong piece,” Yoggy said reminiscing about a former build. “It’s frustrating, but I feel like it teaches, at least me, it teaches me to be patient.”

For many people, frustration is the point where they stop.

For her, it has become instruction. A wrong piece is not failure. It is part of the exercise.

“It taught me a lot,” she said. “It’s like training. You’re training your mind to be more patient.”

That may be the most revealing line in the entire interview. She does not see building as entertainment alone. She sees it as mental conditioning.

A way to practice stillness. A way to strengthen patience.

A way to step outside the repetition of everyday life without losing structure.

“It’s a good little break, stated Yoggy.”

And when asked what it ultimately gives him, the answer came with remarkable clarity.

“It just gives me clarity and peace.”

That is the real build.

Not the ship.

Not the books.

Not the next sets on the shelf.

The real thing being assembled is something internal.

Focus.

Patience.

Calm.

One brick at a time. ❖





THE **minute** HAND

A USAGKA Community Information Update

New Post Office Hours - Beginning April 4th, 2026, the USAG - KA Post Office Days of Operation and Hours will be changing to Tuesday - Saturday from 12 to 6pm.

Also please note that all payments are shifting to a cashless system.

Non-potable water outage - There will be a non-potable water outage on Apr 8 from 8-11am affecting Palm and Ocean BQs, ARC, both AAFES .

My Army Post is ACTIVE - Go to your app store on your mobile device and download the *My Army Post* app. In the upper left corner click on the three horizontal lines and then search for USAG Kwajalein. Once you have Kwaj selected, on the home page click on the Explore button on the lower right, then browse through the needed service or activities. Events will also be listed. Ensure you enable notifications to receive alerts of events. We welcome input to ensure accuracy and complete information.

Meal Cards to Badges - Meal cards are being synched to AIE badges. The process will be done during slow periods at the DFAC. This will alleviate the need to carry the meal card.

Boat Storage Fees- Please work with the Small Boat Marina to stay up to date on your Boat Storage Fees. 480-3643



THE **minute** HAND

A USAGKA Community Information Update

MWR Boats Fuel Price Increase-

Fuel prices for MWR boat usage has increase to \$4.56 with a \$5.00 service fee for each transaction.

Commander's Call- Col. Cannon will be holding the next Commander's Call on Apr 11th at 4pm at the Oceanview.

RMI Shopping Day - AAFES will be conducting another RMI shopping day on 1 May. Limit is \$800 and the time is from 12noon till 6pm. This also includes Roi-Namur.

Housing Survey- Keep an eye out for this year's Army Family Housing Surveys arriving at your door, in your mailbox, and in your email (check you junk mail). Follow the links provided to give your feedback on YOUR house. The links you will receive are tied directly to YOUR quarters.

Facility Managers - Would you like to be the Facility Manager for your BQ or Work building? Facility Managers aid the work orders and maintenance efforts around the Atoll. To get more info or sign-up email Naomi Halsey at: Naomi.Halsey@gov2x.com

Containers - Do you have a container on the Atoll? Matson, Company Storage, or even boat yard. DPW needs to know. Email: usarmy.bucholz.smdc.list.shipping-receiving@army.mil



THE **minute** HAND

A USAGKA Community Information Update

Tree Farm – USAG-KA will be working with U.S. EPA to establish a tree farm to grow young trees that will be planted around the island when other trees are removed for building purposes.

Passport Photos - Passport photos can be obtained at Bldg 805, 2nd floor in the VID Studio. Email KwajaleinHourglass@gov2x.com to arrange an appointment.

Life Support Areas (LSA) - We are replacing the legacy term “Man Camp” with LSA. New signs are going up to name/identify each LSA to clarify the purpose of these spaces and to aid in emergency situations.

Airfield **STOPS!!!!** - Come to a full stop look **BOTH** ways on the runway and in the sky to check for planes before proceeding. You will be ticketed if found in violation.

ICE - To voice your concerns or to say GOOD JOB visit the Interactive Customer Evaluation page for Kwajalein at: https://ice.disa.mil/index.cfm?fa=site&site_id=984

Marshallese - Swimming: tutu

1. tutu iar: To go for a swim on the lagoon side.
2. tutu ilik: To go for a swim on the ocean side.

Do NOT go swimming in the ocean from the shoreline that’s a NO NO



THE **minute** HAND

A USAGKA Community Information Update

HAZMAT Items - Separate household hazardous waste (flammables, corrosives, aerosols, etc.) and place in an individual container next to the trash bins during normal trash days. To arrange large pickup call 480-8858.

ARMA - Need something fixed in your housing, BQ or Office? Go to ARMA : [ARMAhttps://www.armymaintenance.com/arma](https://www.armymaintenance.com/arma) or call 480-3550.

Rain - The rainfall count so far for Kwajalein is:

Friday March 7th: 1.43”

Year Total: 13.70” – Year Deviation: +5.93”

RTS Weather: <https://www.rts-wx.com/forecasts/kwajalein-atoll-forecast/>

The Roller on Youtube - From the home page click on the Crest with the “LIVE” indicator on it. [U.S. Army Garrison Kwajalein Atoll Live Stream](#)

Catch the Airwaves - For music and info - Kwajalein: 99.9^{FM}/102.1^{FM}/104.1^{FM}, Roi-Namur 97.9^{FM} – Roi Rat Radio



THE **minute** HAND

A USAGKA Community Information Update

Access to USAG-KA - Do you have someone coming to Kwajalein? Check out the regulation that controls entry to USAG-KA: https://home.army.mil/kwajalein/7317/4363/4868/USAG-KA_Reg_190-10_Entry_and_Exit_Control_Signed_MAR2026.pdf

- **Day Pass Form:**
https://home.army.mil/kwajalein/4217/6064/8721/USA-KA_FORM_2_Day_Pass.pdf – Then needs to be sent to the DSC Mailbox at: usarmy.bucholz.id-pacific.mbx.usag-ka-dsc@army.mil
- **Overnight Guests Form 480:**
https://home.army.mil/kwajalein/7617/6481/7510/Form_480_Overnight_Guests.pdf – Then emailed to E/E: usarmy.bucholz.id-pacific.mbx.usag-ka-e-e@army.mil.

Events - Events can be found on Kwajalein Community Events FB

- **Easter Egg Hunt** - Brandon Field, Apr 4th 5pm
- **Pajama Party** – Oceanview, Apr 4th 8pm
- **NHS Pancake Breakfast** – MP Room, Apr 6th 8-10am
- **Kwajalein Craft Fair** - CRC Gym, Apr 6th
- **GSES Art Show** - GSES Art Room, Apr 14th 4:30pm
- **KJSHS Art Show** - GSES Art Room, Apr 17th 4:30pm
- **KSS Prom** - Country Club, Apr 19th 5pm
- **KHS Band Concert** – MP Room, Apr 30th 6:30pm
- **GSES Band Concert** – MP Room, May 1st 5:15pm
- **KSS Scholarship Night** – MP Room, May 2nd 6pm
- **KSS Graduation Night** – MP Room, May 15th 7pm

Have an upcoming event? Email [HERE](#) to get the word out.

Kwajalein Reclaimed Water Standard Violation

The Reclaimed Water System Document of Environmental Protection (DEP) requires public notification when the standards for reclaimed water are not met. On 15, 16, and 28 February 2026, the minimum chlorine residual concentration at the entry point to the reclaimed water distribution dropped to 0.6 ppm (parts per million), 0.6 ppm, and 0.7 ppm, respectively for less than 16 hours each time. The minimum chlorine residual concentration standard is 1.0 ppm. Chlorine is added as a disinfectant at the entry point to the distribution system. **No health-based restrictions on the normal use (irrigation, vehicle washing, etc.)** of reclaimed water are necessary. There is no threat to public health or the environment resulting from this chlorine minimum. Questions? Contact V2X Environmental at 480-0722.

Jorraan Eo Ilo Reclaimed Water System Eo Ion Kwajalein

Ekkar non Reclaimed Water Document eo an Environmental Protection/ak naetan (DEP) aikuj karon jukjuk in ped, elane standards eo ilo jikin liklik dren ejjab tobar jonon ko. . Ilo 15, 16, im 28 February 2026, dretton chlorine residual concentration eo ej dreton non jikin liklik dren in ekar ajej im walloltak non jonin 0.6 ppm (parts per million), 0.6 ppm, im 0.7 ppm respectively ilo an driklok jen 16 awa ilo kajojo awa. Jonon chlorine residual concentration standard eo 1.0 ppm ilo ar kar ilik chlorine non karreoiki jen jonon in ej dreton ilo an driwojlok jen jikin liklik in. **Ejjab jelet ejmour non karon im rejan ikkijeen kojerbal dren in (non wutdrikdrik, kwali waa ko, im jermal ko eirlokwo)** non aikuij ko **jet**. Jokjok in eban jelet ejmour ak jukjuk bed in ilo an kalik karelok jen drettan chlorine eo. Kajitok kir V2X Environmental ilo 480-0722.

ALWAYS CALL...

...if your building's Fire Alarm is sounding

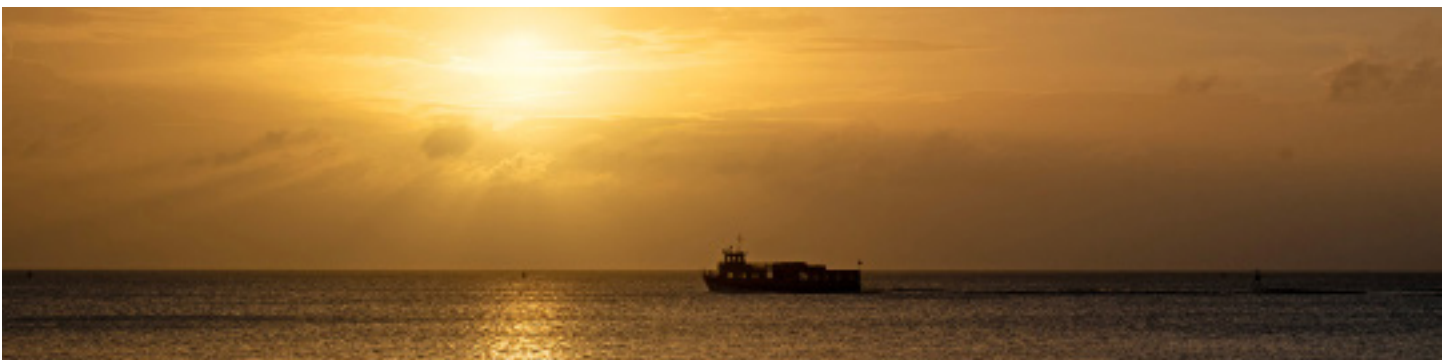

Meal Card scanning from AIE Badge



FROM THIS

TO THIS
AIE BADGE



We have begun transitioning the Meal Card system to accept the new AIE badge, replacing the need to carry a meal card. Thank you for your patience as we streamline your dining experience. If you have any questions or concerns, please ask for a manager at the dining facility and we can explain the process.

ATTENTION...

Non-Potable Water Restriction

Non-potable water usage on Kwajalein has increased over the last month and is currently greater than we can sustain.

Please restrict irrigation of grass and plants to less than 30 minutes every other day during the dry season to conserve this limited resource. Please report any suspected water leaks to the Service Desk at 480-3550.

Call Stan at 480-4400 with any questions.



BARGAIN BAZAAR: COMMUNITY & MISSION

- Volunteer-run resale shop on Kwajalein
- Donations fund scholarships & school grants
- Supports education across the Marshall Islands & Micronesia
- Open Every Wednesday 4:30 to 6:30 PM
& 1st Saturday 4:00 to 6:00 PM
- Promotes reduce, reuse & recycle
- A hub for connection and community

We Accept:

Clean clothing, baby gear, shoes, linens, kitchenware, décor, working electronics, books, toys, school supplies, jewelry & holiday décor

We Do NOT Accept:

Food or medications

How to Donate:

- Stop by DSC for gate access
- Bring items directly to BB door
- Wrap breakables & attach cords

Donations
ALL PROCEEDS SUPPORT THE YWCA EDUCATION ASSISTANCE COMMITTEE.
KOMMOLTATA FOR YOUR DONATION!

¡No Wipes in Our Pipes!

Many household products are labeled as FLUSHABLE.
THEY ARE NOT.



KOJBAROK PIPES KO: JAB FLUSH WIPES KO!
Jab Likiti “Flush ii” ak julaki” ilo toilet bowl ko.

*E-wareness



Annual Hazardous Materials, Wastes, and Petroleum Product

(HMWPP) Training (ENV-100) and Spill Response Awareness Training (ENV-110)

Training is required for organizations/departments that manage HMWPP storage areas (i.e., facilities that store an aggregate quantity greater than 55-gallons of HMWPP). Each HMWPP facility is to have at least two trained custodians (primary and alternate).

KWAJALEIN (at the Religious Education Building, REB Conference Room):

Tuesday, April 28th, 2026

- 9:00 a.m. – 11:00 a.m.
- 1:30 p.m. – 3:30 p.m.

Thursday, April 30th, 2026

- 9:00 a.m. – 11:00 a.m.
- 1:30 p.m. – 3:30 p.m.

ROI-NAMUR (at the TRADEX Conference Room):

Friday, May 1st, 2026

- 9:30 a.m. – 11:30 a.m.

Personnel will only need to attend ONE of the sessions. Pre-registration is not required to attend training. Questions? Please Call the Environmental Department at 480-2633.



VOLUNTEER

The Mic Shop is always looking for Volunteers!

It is a great way to connect with the community and help our mission of Education Grants and Scholarships

Contact **Jacki Blumenauer** (jackiblume64@hotmail.com) or stop in the Mic Shop

Only 2 hours of your time each month to make a big difference

Sundays and Mondays: 12:00pm - 2:00pm
Wednesdays and Fridays: 4:30pm - 6:30pm

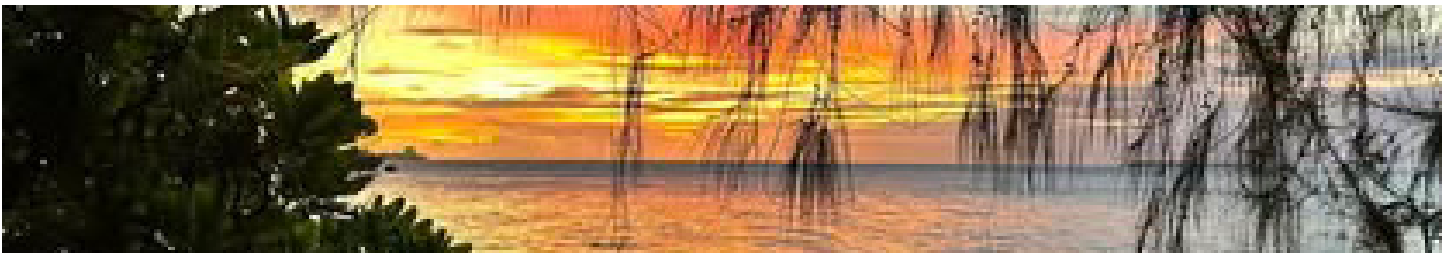

WIN A SIGNED COPY OF THE RAREST BOOK ON KWAJ!

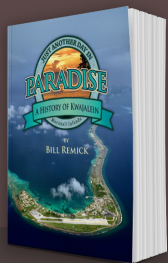

\$10.00 Per Ticket

100% OF ALL PROCEEDS GO TO EDUCATION GRANTS FOR SCHOOLS IN ALL OUTER ISLANDS.

YOKWE YUK WELCOME CLUB
SPRING RAFFLE

MARCH 20—APRIL 12

DRAWING WILL TAKE PLACE AT YACHT CLUB

SPRING BREAK MUSIC FEST ON APRIL 12

Sundays and Mondays: 12:00pm - 2:00pm
Wednesdays and Fridays: 4:30pm - 6:30pm

Tickets available at the Mic Shop until raffle (April 12th)

Tried to STOP, But You
Can't

Has Alcohol become an
OBSESSION

There is a Solution to
the Problem with Alcohol

**REACH OUT FOR
HELP**

ALCOHOLICS ANONYMOUS

ROOM 214 KWAJ RELIGIOUS EDUCATION
BUILDING (UPSTAIRS)

BUILDING #671

FRIDAY-SATURDAY-SUNDAY

7PM-8PM

QUESTIONS? EMAIL: kwajchapel@gmail.com
OR CALL 480-2116



**American
Red Cross**

Service to the Armed Forces

Volunteer Opportunity at Kwajalein Atoll

Join the American Red Cross and help bring our Services and Programs to the Kwajalein Atoll community!

Online & Virtual Training Provided

No experience needed!

We provide all necessary training. Just bring your passion and commitment to helping others!

Contact **Alana Wilson** at alana.wilson@redcross.org

Let's work together to build a more prepared and resilient community.

ISLAND WIDE TRASH PICKUP

MONDAYS 12:30-2:30PM

For more information, email Caedmon Rios at
riosc@kwajaleinschools.org



March 16th
CRC past all Oceanside Homes

March 23rd
Snake Pit to Kwaj Lodge

March 30th
Kwaj Lodge to
Airplane Warning Sign

April 13th
Old Boy Scout area through
Dirt path along Golf Course

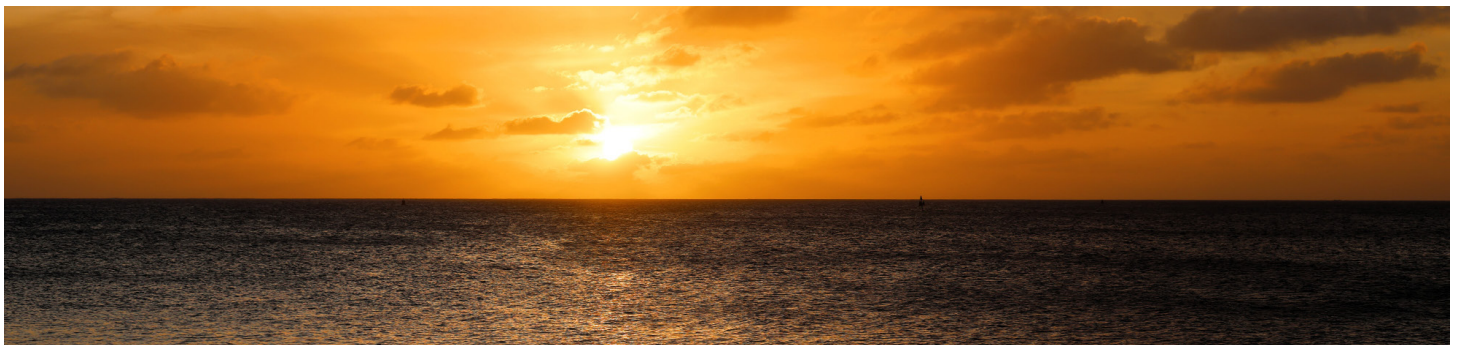

Kwajalein Atoll

Do you have a Concern or Kudos?
Go to the Interactive Customer Evaluation
and give us your feedback.

**GO
TO**

ICE
INTERACTIVE CUSTOMER EVALUATION



Kwajalein to Ebeye Ferry Schedule



- C-BADGE WORKERS** have priority, EXCEPT on the following runs:
 - 0650 run (arriving at Ebeye at 0715) High Schools students have priority ridership.
 - 0720 run (arriving at Ebeye at 0745) and the 1600 run (departing from Kwaj) Kwajalein School Guest students have priority rider-ship.
- On Stevedoring days, workers involved with cargo operations have priority on the 2000 ferry.
- SMOKING, TOBACCO, CHEW, BETEL NUT, EATING and DRINKING ARE PROHIBITED ON ALL FERRIES.
- Boats will not be overloaded: Maximum capacities are 150 passengers (CATs and ferries) and that number may be reduced during inclement weather or at the Captain's discretion due to safety concerns.
- Meck catamarans may operate on a dynamic schedule and will be available by calling Meck Management.
- SATURDAY ONLY – THERE WILL NOT BE A 2130 FERRY INSTEAD THE FERRY WILL DEPART AT 2200.**

EBEYE – Tuesday to Saturday

EBEYE – Sunday & Holiday

ETD	ETA	ETD	ETA	TYPE	ETD	ETA	ETD	ETA	TYPE
	EBEYE	EBEYE	KWAJ	VESSEL	KWAJ	EBEYE	EBEYE	KWAJ	VESSEL
0245	0310	0315	0340	FB N/1	0400	0425	0430	0455	FB N/1
0420	0445	0450	0515	FB 1	0500	0525	0530	0555	FB 1
0450	0515	0520	0545	FB 2	0600	0625	0630	0655	FB 1
0520	0545	0550	0615	FB 1	0830	0855	0900	0925	FB 1
0550	0615	0620	0645	FB 2	1140	1205	1210	1235	FB 1
0620	0645	0650	0715	FB 1	1530	1555	1600	1625	FB 1/N
0650	0715	0720	0745	FB 2	1700	1725	1730	1755	FB N
0720	0745	0750	0815	FB 1	2000	2025	2030	2055	FB N
0900	0925	0930	0955	FB	2200	2225	2230	2255	FB N
1140	1205	1210	1235	FB 2/A	Holidays only ADD extra run below				
1300	1325	1330	1355	FB	1830	1855	1900	1925	FB N
1440	1505	1510	1535	FB A	Monday				
1600	1625	1630	1655	FB A	0315	0340	0345	0410	FB N/1
1700	1725	1730	1755	FB A	0500	0525	0530	0555	FB 1
1730	1755	1800	1825	FB N	0600	0625	0630	0655	FB 1
1800	1825	1830	1855	FB A	0720	0745	0750	0815	FB 1
1830	1855	1900	1925	FB N	0830	0855	0900	0925	FB 1
1900	1925	1930	1955	FB A	1140	1205	1210	1235	FB 1
2000	2025	2030	2055	FB N	1440	1505	1510	1535	FB 1/N
2130	2155	2200	2225	FB N	1645	1710	1715	1740	FB N
(TUESDAY-FRIDAY) 2130 is final run of day					1745	1810	1815	1840	FB N
2200	2225	2230	2255	FB N	1900	1925	1930	1955	FB N
SATURDAY - No 2130 ferry; 2200 is final run of day					2000	2025	2030	2055	FB N
	FB =	Ferry	Boat		2130	2155	2200	2225	FB N



Roi-Namur / Enniburr Ferry Schedule



FIRST PRIORITY: BADGE WORKERS
 Passengers are to board and disembark ONLY at the gangway area. As deemed by the Captain, any passengers, who are unruly and pose a safety hazard to the crew, other passengers, or vessel will not be allowed to ride the ferry. Maximum passenger load is 150 passengers.
SMOKING, TOBACCO CHEWING, BEETLE-NUT, EATING and DRINKING ARE STRICTLY PROHIBITED ON ALL FERRIES.
 The clock kept by the ferry Captain is the official time. Departure times from Roi-Namur are mandatory times. Return times to Roi-Namur may change slightly due to the offloading of water at Enniburr.
 Any questions? Please call the Port Captain in Kwajalein, 480-2173.

Tuesday to Saturday

Run Number	ETD Roi-Namur	ETA Enniburr	ETD Enniburr	ETA Roi-Namur	Vessel
1	0520	0535	0555	0610	FB
2	0730	0745	0805	0820	FB
3	1250	1305	1325	1340	FB
4	1715	1730	1750	1805	FB
5	1940	1955	2015	2030	FB

Sunday-Monday-Holiday

Run Number	ETD Roi-Namur	ETA Enniburr	ETD Enniburr	ETA Roi-Namur	Vessel
1	0650	0705	0725	0740	FB
2	0940	0955	1015	1030	FB
3	1450	1505	1525	1540	FB
4	1940	1955	2015	2030	FB



***EASTER EGG HUNT
VENDORS WANTED***

**Saturday, April 4, 2026,
5:00 PM – 7:00 PM AT BRANDON FIELD**

*Let's make this Easter an awesome experience for all ages.
Let's give Kwaj community more options to spend a day out.*

**To register as a vendor
Contact MWR at Grace Sherwood Library
@ 480-3331 or Email: oana.neagu@gov2x.com**



Hours of Operation
TUESDAYS - SATURDAYS
07:30 AM - 4:30 PM

Lunch Break
11:30 - 12:30

**Call the Kwajalein Veterinary Clinic
to schedule your appointment or e-mail**

 **480-2017**

 **Kwajvetclinic@acuityinternational.com**

Kwajalein Island Trash & Recycling

Residential Trash Collection 480-1760
Yard Vegetation Collection 480-1890
Hazardous Waste Pickup Line 480-8858



TRASH & RECYCLING PICKUP SCHEDULE

The Green Residential TRASH receptacles are collected every **Tuesday and Friday**.
The blue RECYCLE bins are also collected every **Tuesday and Friday**.
The large black General Solid Waste Community Containers are emptied on Monday, Wednesday, Thursday, and Saturday.

Safety First! Please keep any curious children away from the Compactor Truck as it feeds contents into the truck.

Recyclable materials are also collected by both *solid waste* and *horizontal maintenance personnel*, in conjunction with general trash collection. Currently the island only recycles glass, aluminum, metal, and bulk organic materials. **Cardboard and plastics are not recycled materials on Kwajalein.** These items should be placed into the general trash stream for disposal/incineration.



Residential users will be given a **green trash** receptacle and a smaller **blue receptacle** for recyclable materials. It is requested that residences place their recyclable items into the blue containers, and stack larger materials next to the bins. Lawn clippings and leaves should be bagged and placed next to bins. Palm fronds and coconuts should also be stacked up next to the bins for removal by horizontal maintenance personnel.



Kwajalein /Roi-Namur Driver Licensing

Kwajalein classes are every Wednesday.

- 9:00 a.m. Marshallese
- 12:45 p.m. EXPATS **by appointment only as class size is limited**
- Building 856, Room 101 at the Vehicle Maintenance Compound
- To register, send email to the following: George.parker3@gov2x.com and Wilson.Kaisha@gov2x.com or stop by Bldg 856, Room 101

Roi-Namur Classes are every 2nd Friday (time base on flight schedule and location is Building C). No registration needed for Roi classes. Send any questions to the emails above.

Now Available by Appointment...

PASSPORT PHOTO SERVICES

PASSPORT

Located on the 2nd floor of Bldg. 805 on Kwajalein. When taking your photo, remember the following guidance for a successful shoot:

- Directly face the camera without tilting your head.
- Have a neutral facial expression with both eyes open and mouth closed.
- Take off your eyeglasses, headphones or wireless hands-free device.
- Do not wear a uniform, clothing that looks like a uniform, or camouflage.
- Remove hats or head coverings or submit a signed statement or doctor's note that says you must wear it for religious or medical purposes.



*United States
of America*



To schedule an appointment,
contact IMD/AVD personnel at:

KwajaleinHourglass@gov2x.com



FOLLOW US AT THESE LOCATIONS



Click QR Code to jump to social page

Kwajalein



MIA Project

NEVER FORGET.

<https://kwajaleinmiaproject.us/>

COMMUNITY CLASSIFIEDS

Submit Announcements to the Roller Channel and The Kwajalein Hourglass

OPEN CALL FOR ANNOUNCEMENTS
The island community is invited to submit listings for events and for sale items; announcements; department trainings; safety updates; public service messages; and thank-you messages.

Preparing Your Message

For questions about your messaging, please reach out to the USAG-KA Public Affairs Office at 480-4848.

Ads should always include a point of contact, phone number and/or email address.

Private parties, fundraisers and events requesting and/or accepting donations are typically not allowed for publication per AR 360-1. Fundraisers and support activities for private and schools-based organizations, scouting groups, civic clubs and other listings may be subject to a legal counsel review to determine their eligibility for publication.

Formatting Your Listings

It is recommended that graphical adver-

tisements and announcements intended for the Hourglass and the AFN Roller Channel be formatted as PowerPoint slides.

Graphic designers are asked to maintain a generous margin (.75-1-inch) around all sides and to size fonts no smaller than pt. 20.

If your Roller Channel advertisement requires a special expiration date, please note this for the Roller team in the body of your message.

Deadlines for Submissions

Send advertisements for the Kwajalein Hourglass and the AFN Roller Channel to kwajaleinhourglass@gov2x.com on Wednesdays by close of business/Thursday morning.

Roller Channel ads are accepted on a rolling basis by 4 p.m. for a mid-week and late-week update. Ads received after 4 p.m. will be loaded in the next update. Please ensure you submit ads in good time to ensure timely upload.

For more information, reach out to the USAG-KA Command team through the USAG-KA Facebook page.

ANNOUNCEMENTS

AFH Construction Is Ongoing. Nan, Inc. Construction is scheduled to commence the telecommunication scope of work for the Kwajalein Army Family Housing project in our community. Residents and commuters should be aware of possible changes in traffic patterns and to plan their routes accordingly. Nan, Inc. Construction is committed to minimizing any inconveniences, and we will strive to ensure a smooth and efficient construction process.

ArMA. Log in to ArMa, the Army Maintenance Application, to report issues for all buildings maintained by the Department of Public Works. Contact Public Works at 480-3550.

CAC Office. Before your visit to the Common Access Card Office, ensure all paperwork is completed by your human resources representative before making an appointment. Bring two forms of government-issued IDs with you. Walk-in appointments are welcome, but there may be a wait. CAC Office Hours, Bldg. 835, are Tuesday – Saturday, 8 a.m. – 4 p.m.; (Lunch: noon - 1 p.m.). Call 480-8496.

Demolition at the Capt. Louis S. Zamperini Dining Facility. Phase three of the Zamperini DFAC demo has begun and is projected to be finished March 2026 for the dining and serving area. Be careful around the dining facility during the phases.

Do Not Take Cultural Artifacts. It is illegal to remove cultural resources from the atoll. This includes any protected species, unexploded ordnance, WWII-era artifacts and ancient Marshallese artifacts. These resources are protected under U.S. federal and RMI law. Contact the Kwajalein Archaeology Office at 480-8867.



Contact the USAG-KA Sexual Harassment/ Assault Response and Prevention Victim Advocate

Captain Tameka Edmonson
SHARP Victim Advocate

Work: 480-1419 or

Major Matthew DeMartino
Work: 480-1402

USAG-KA SHARP

Pager: 808-580-3241
DOD SAFE Helpline: 877-995-5247

Emergency Management. Visit the USAG-KA Emergency Management webpage, <https://home.army.mil/kwajalein/index.php/my-fort/EM>; 2) Click on "Mass Notification"; 3) Follow the registration instructions.

E-Wareness: It is each driver's responsibility to ensure vehicles are not leaking fluids other than air conditioning condensate. Call 911 to report spills and arrange with automotive for routine maintenance. Please call Environmental at 480-0722 with questions. Ej an ri-kator eo eddo non lolorjake bwe wa eo ejjab leak jabdewot oil ijelak in drennin air condition eo jen wa eo. Ne elon jabdewot leak/lutok in oil jen wa eo, Kiir 911 non report- e lutok eo. Ak kiir Environmental ilo 480-0722 non kajitok.

Fire Safety Tips. Some pets are chewers. Watch pets to make sure they don't chew through electrical cords. Pets are curious. They may bump into, turn on, or knock over cooking equipment. Keep pets away from stoves and countertops. Make sure pets are included in your family's fire evacuation plan. Build an evacuation kit for each pet in your household.

Flights. Please note that all flights are subject to change. For the latest update on your flights on United, ATI or Air Marshall Islands: ATI: 480-2169; AMI: 480-3469; United: 480-4852 or 1-800-UNITED1; Air Terminal Services: 480-2660; Flight Information Recording: 480-3589

UA Schedule Effective Now: Monday and Friday—UA 155 (HNL); Check-in 2 – 4:50 p.m.;

Wednesday—UA 133 (HNL); Check-in 2 – 4:15 p.m.; Tuesday and Saturday—UA 154 (GUM); Check-in 10:45 – 11:15 a.m.

FlyRoi Reservations. To schedule reservations and for correspondence related to flights, email LCVKwajaleinFlyRoi@versar.com.

How to dress in the RMI. Out of respect for the Marshallese culture, residents are asked to dress appropriately when visiting Ebeye, Third Island, or anywhere within Kwajalein Atoll. Women should wear clothing to cover shoulders and knees. None are permitted to wear shorts when visiting churches on Ebeye. Men should wear long slacks to church.

Kwaj Small Boat Marina hours are 7:30 a.m. – 6 p.m. Friday through Monday, and on holidays, excluding Thanksgiving and Christmas. Morning boat reservation times are from 7:30 a.m. – noon. Afternoon boat reservations are from 1 – 5 p.m.

Not Feeling Well? Call 480-2223 to make an appointment for a COVID-19 test, Tuesday through Saturday from 7:30 a.m. – 4:30 p.m. If you are not feeling well, please wear a mask when you are around others in the community.

Operational Security. See something, say something. All employees on USAG-KA are required to receive annual Threat Awareness and Reporting Program training provided by KRO; Reporting: Report suspicious activities to the Kwajalein Resident Office at 480-9859/1293/8006 at Bldg. 1163.

PCS & Vacation Tips. Notify the post office before leaving for 30 days or PCS'ing. Per DOD 4525.6-M, mail is only allowed to be held for 30 days with or without prior notice. Mail is considered unclaimed on day 31 and will be returned to the sender. Email the post office to authorize pick up for your mail and packages. When PCS'ing, provide a forwarding address. Contact Jose Burgos-Rivera with questions at 480-3461 and Jose.Burgos-Rivera@gov2x.com.

Salon Walk-Ins. Surfside Salon Walk-In Appointments are available on Fridays from 1:30 - 6 p.m.

Smoking. USAG-KA, smoking is permitted in designated smoking areas only. Smoking and cigarette butt receptacles must be at least 50 feet from the entrance of facilities.

Taxi Service. Call 480-TAXI (8294) or 3341 to

HELP WANTED

For employment with contractors within the U.S. Army Garrison - Kwajalein Atoll please check contractor company websites for employment opportunities.

book your ride at least 24 hours in advance of check-in time.

Millican Family Pool Hours. Closed for cleaning on Thursdays. Open noon to 5 p.m. Tuesdays, Wednesdays, Fridays and Saturdays. Open 11 a.m. to 5 p.m. Sundays and Mondays.

The NEC Testing Center Is Open to the Community - Giving you the head start you need to thrive! - Open Tuesday through Saturday by appointment
Authorized Pearson VUE Test Center. Schedule A test Today!
NEC testing Center, 480-4344, FN 1008-131
ACUITY International

Kwajalein / Roi Namur Licensing Classes on Kwajalein are every Wednesday @0900 Marshallese @1245 Expats (by appointment only as class side is limited)
Classes are in Bldg. 856 Rm 101, Vehicle Maintenance Compound
Roi classes every 2nd Friday in Bldg. C, timed based on flight schedule
No registration needed for Roi classes.
To register, send email to either of the following:
George.Parker@gov2x.com
Wilson.Kaisha@gov2x.com
...or stop by Bldg. 856, Rm 101



OPSEC IS NOT RETROACTIVE.

THINK BEFORE YOU SHARE INFORMATION. ONLINE AND OFFLINE.

Like and share @USArmyOPSEC

ROI-NAMUR FOR AIRCRAFT!!

Stop and look both ways for aircraft on Perimeter Rd., Pandanus Rd., Eleanor Wilson Rd.
If aircraft are on approach or taking off, you must hold your position and wait!

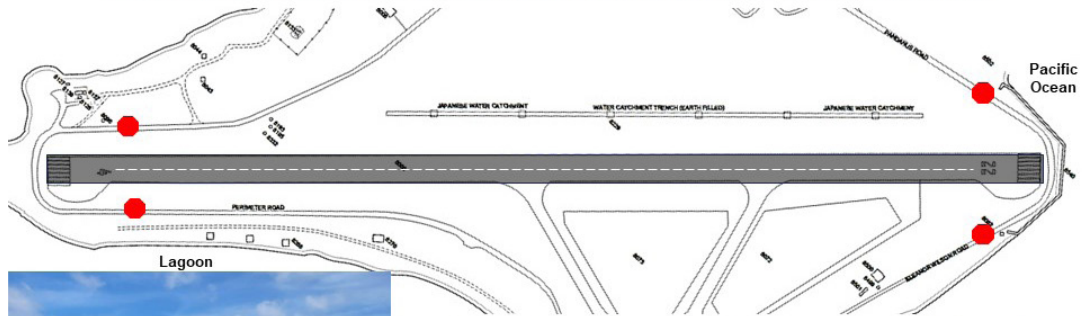

Stop at designated signs and look for aircraft landing or taking off.

If you see an aircraft, hold your position at the stop sign and wait until the aircraft has landed or departed before moving.

KWAJALEIN FOR AIRCRAFT!!

Please remember to stop and look both ways for aircraft on Zeus Blvd. or Ocean Rd.
If aircraft are on approach or taking off, you must hold your position and wait!

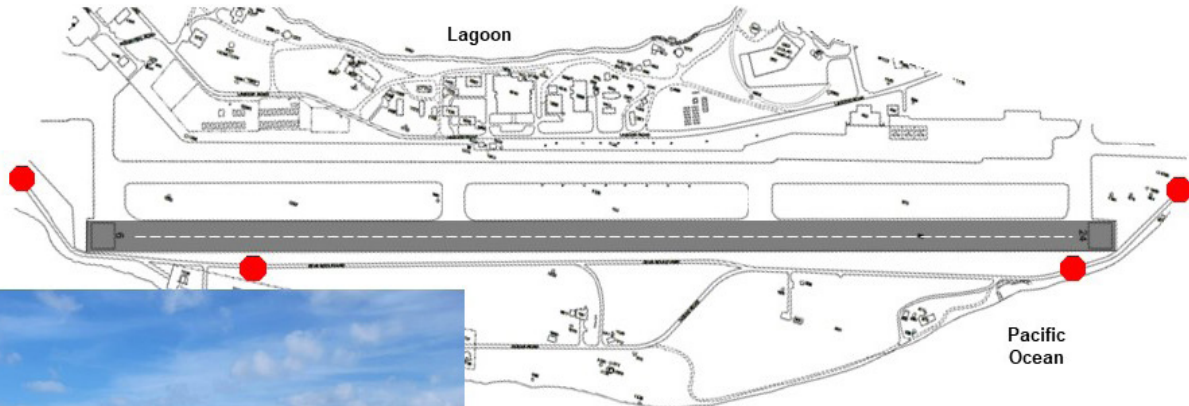

Stop at designated signs and look for aircraft landing or taking off.

If you see an aircraft, hold your position at the stop sign and wait until the aircraft has landed or departed before moving.

NOW SHOWING at the YUK THEATER

SATURDAY, APRIL 4
"Finding Nemo" (2003)
(G) 100 min.

SUNDAY, APRIL 5
"Ant-Man and the Wasp" (2018)
(PG-13) 118 min.

SATURDAY, APRIL 11
"Raiders of the Lost Ark" (1981)
(PG) 115 min.

SUNDAY, APRIL 12
"The Blues Brothers" (1980)
(PG-13) 133 min.



SATURDAY, APRIL 11
"Ice Age – Collision Course" (2016)
(PG) 94 min.

SUNDAY, APRIL 19
"Iron Man" (2008)
(PG-13) 126 min.

SATURDAY, APRIL 25
"Ralph Breaks the Internet" (2018)
(PG) 112 min.

SUNDAY, APRIL 26
"Shazam!: Fury of the Gods" (2023)
(PG-13) 130 min.



WEEKLY TROPICAL WEATHER THREAT OUTLOOK

RTS WEATHER STATION STAFF

Discussion:

March received 6.5 inches of rain, which was about 3.0 inches above normal for the month. We have received 18.76" of precipitation for the year, putting us at about 8 inches above normal. We will see significantly above normal shower coverage for the next seven days over the atoll mainly toward the end of the week. Today represents our driest day for the next few days. Tomorrow we will see increased shower coverage due to wind speed convergence, then we start to see the effects of a significant trough associated with a circulation over the southern RMI with significant shower coverage heaviest on Monday with the transit of the trough axis (winds ENE-E-ESE). Increased shower coverage will continue into the early work week. We observed one lightning strike within five miles of the weather station last week. A thunderstorm day is defined by an "in situ" lightning strike, meaning light-

ning is observed or thunder is heard within five miles of the Kwajalein airfield. The greatest risk of lightning is Saturday morning with a more significant risk on Monday. The Madden-Julian Oscillation's (MJO) has become disorganized and having little effect on the RMI. The Intertropical Convergence Zone (ITCZ) is incoherent but will strengthen and assist this weekend's trough over the central RMI. El Nino Southern Oscillation (ENSO) is in la Nina conditions for our part of the Pacific. This means sea-surface temperatures (SST) between the RMI and the Date Line are cooler, having an overall negative impact on the RMI's rainfall coverage. It is expected that conditions will become neutral in April helping the RMI maintain normal precipitation coverage outside of other parameters. El Nino conditions are becoming more likely this summer, having a positive impact on above normal precipitation for the RMI.

Tropical Cyclones:

None. Last week's circulation collapsed into a trough when the trade-winds reestablished.

Damaging West Winds / Westerly Swell:

Not anticipated. There may be periods of light westerly winds experienced tomorrow.

Swell / Tid Inudation For Kwajalein Atoll and Wake Island and Winds:

The full moon is today with a peak high of 4.7 feet tomorrow. Winds: trade-winds have reestablished and will hold for the most parts between 11 and 16 knots out of the ENE to ESE slightly lower when out of the southeast, increasing to the upper teens on Sunday and Monday but slightly lower when out of the southeast. Gusty winds well into the 20s and low 30s for short periods of time are possible near heavy showers on Sunday and Monday. A Small Craft Advisory (SCA) is possible on Monday for

short periods of time and during gusty outflow events near heavy showers. A High Surf Advisory (HSA) is not expected.

Purpose:

This weekly briefing is delivered Thursday mornings to island leadership. The intention of this briefing is to provide situational awareness of weather events that may interrupt operations and transportation around Kwajalein, to/from Hawaii and Guam, and in the Wake vicinity. The main threat assessed in this brief is existing and potential development of tropical cyclone activity. This brief also provides an outlook of abnormal winds, sea state, and precipitation guidance for next 7 days around the Kwajalein Atoll. The distribution list will also receive updates on any developing tropical cyclone activity in the Kwajalein region that occur between the weekly outlook products. ▾

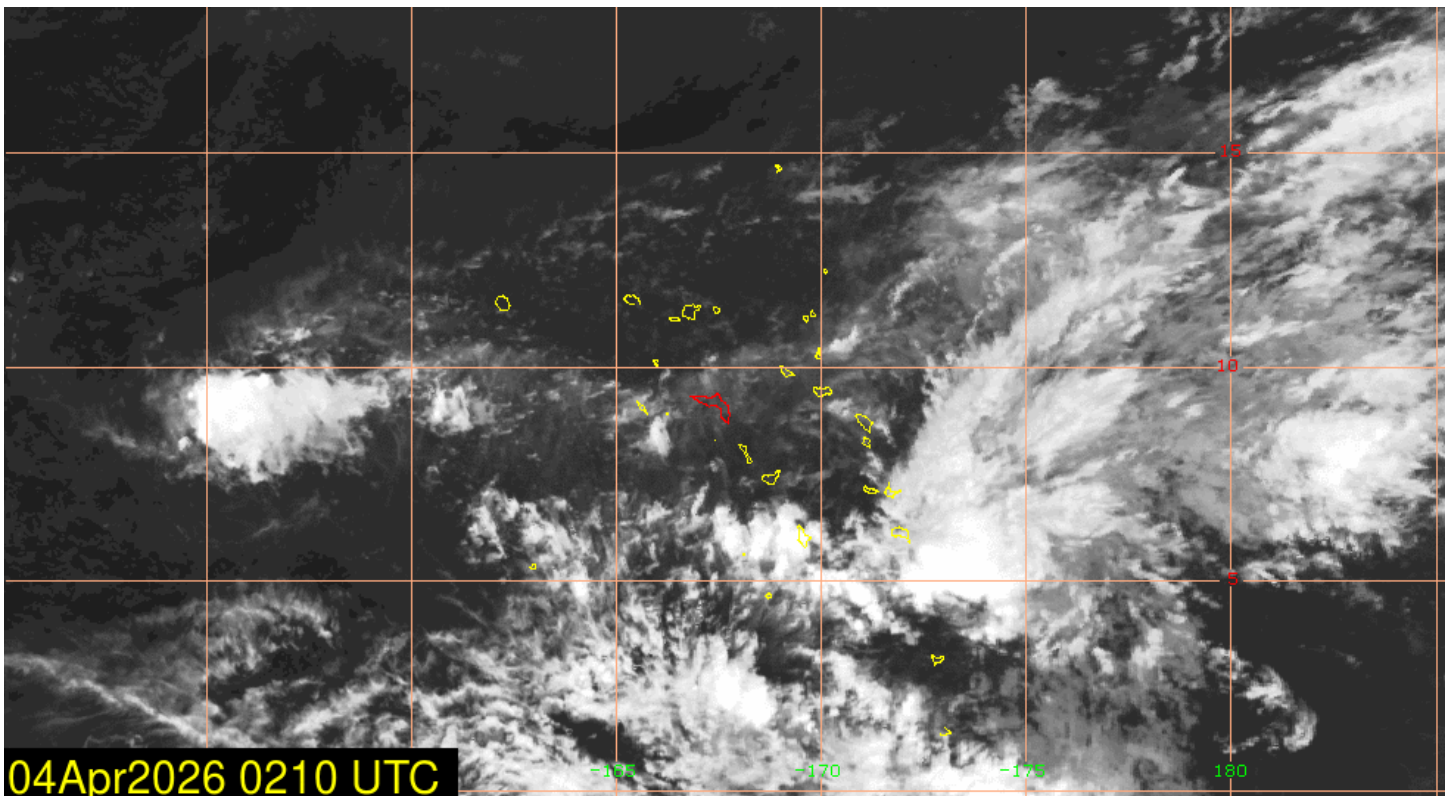

WEATHER

RTS WEATHER STATION STAFF

WEATHER DISCUSSION

Increasing showers are expected heading into the weekend as a broad low-pressure system approaches Kwajalein Atoll. This system will gradually moisten the atmospheric column and enhance low-level convergence. Winds during this period will fluctuate in the teens, gradually shifting from northeast to east-southeast. Over the weekend, as the system passes closest to the atoll, expect a prolonged period of unsettled weather, including episodes of heavier showers and an increasing chance of thunderstorms. Winds may strengthen further at times into the low 20s as the pressure gradient tightens between the low-pressure system and the subtropical ridge to the north. Showery conditions associated with this system are likely to persist into the start of the workweek.

SATURDAY

Partly sunny with isolated to widely scattered showers and stray thunderstorms.

Winds NE-E at 13-18 knots with higher gusts possible near showers.

SUNDAY

Partly sunny with isolated showers and a possible stray thunderstorm. Winds NE-E at 7-12 knots with higher gusts near showers.

MONDAY

Cloudy with scattered showers and isolated thunderstorms. Winds E-SE at 13-18 knots with higher gusts near showers.

NEXT WEEK

Wet weather will persist into next week as the flow becomes southeasterly, drawing deeper moisture into the region while the low shifts west of Kwajalein Atoll. Periods of heavy rain and isolated thunderstorms will remain possible through the upcoming week. Meanwhile, winds will stay elevated, generally in the mid-teens. ⚡

SUN-MOON-TIDES

	SUNRISE SUNSET	MOONRISE MOONSET	HIGH TIDE	LOW TIDE
SUNDAY	6:45 a.m. 6:59 p.m.	9:27 p.m. 8:32 a.m.	5:38 a.m. 4.5' 5:49 p.m. 3.7'	11:53 a.m. -0.2' 11:46 p.m. -0.1'
MONDAY	6:44 a.m. 6:59 p.m.	10:18 p.m. 9:17 a.m.	6:02 a.m. 4.3' 6:13 p.m. 3.3'	12:20 p.m. 0.1' -----
TUESDAY	6:44 a.m. 6:59 p.m.	11:10 p.m. 10:05 a.m.	6:27 a.m. 4.0' 6:36 p.m. 2.9'	12:07 a.m. 0.2' 12:49 p.m. 0.4'
WEDNESDAY	6:43 a.m. 6:59 p.m.	----- 10:55 a.m.	6:54 a.m. 3.6' 7:01 p.m. 2.5'	12:29 a.m. 0.5' 1:21 p.m. 0.8'
THURSDAY	6:43 a.m. 6:59 p.m.	12:01 a.m. 11:47 a.m.	7:28 a.m. 3.2' 7:33 p.m. 2.1'	12:50 a.m. 0.9' 2:08 p.m. 1.2'
FRIDAY	6:42 a.m. 6:59 p.m.	12:52 a.m. 12:40 p.m.	8:27 a.m. 2.8' 10:03 p.m. 1.8'	1:16 a.m. 1.3' 4:10 p.m. 1.6'
APRIL 11	6:42 a.m. 6:59 p.m.	1:40 a.m. 1:32 p.m.	11:18 a.m. 2.7' -----	2:48 a.m. 1.7' 7:18 p.m. 1.3'

FOR QUESTIONS ABOUT ISLAND LIFE AND ARMY REGULATIONS, PLEASE CALL THE COMMANDER'S HOTLINE AT 480-1098. FOLLOW THE UPDATES REGARDING SAFETY INFORMATION, EVENTS AND OFFICIAL COMMAND ACTIVITIES.

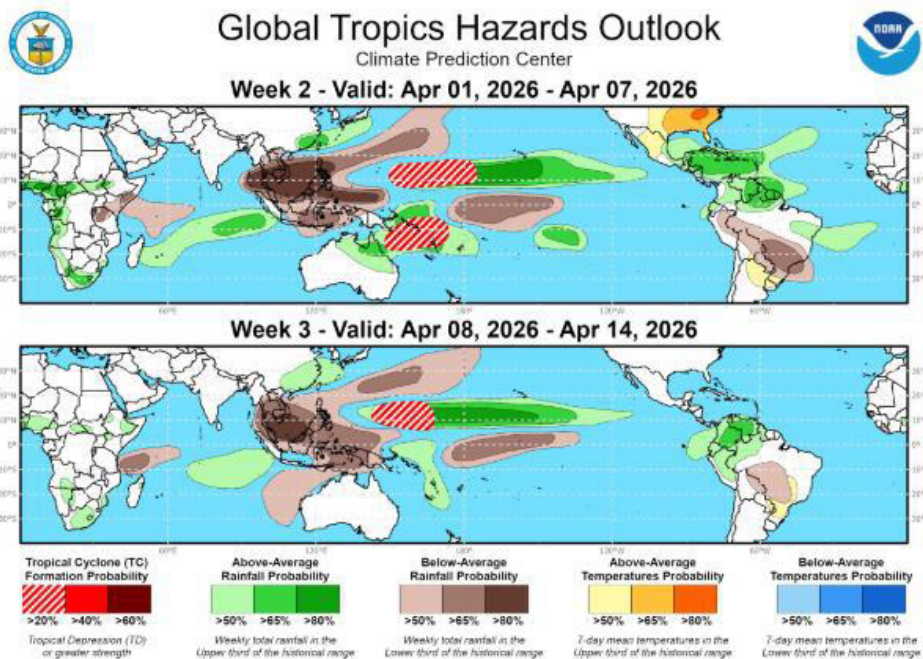

A tropical sunset scene with a palm tree silhouette in the foreground and the sun low on the horizon over the ocean. The sky is filled with soft, golden light and scattered clouds. The sun is positioned in the upper center, casting a bright glow and creating a shimmering reflection on the water's surface. The palm tree's fronds are dark against the bright sky, framing the scene. The overall mood is peaceful and serene.

Until Next Week!